

Walk everywhere  
restaurants,  
galleries,  
shops,  
museums,  
parks,  
work.



Announced  
Harris Teeter  
Grocery  
store will be  
opened  
as part of the  
Seaboard  
Station **U**

Mordecai Place is a family friendly, eclectic neighborhood of tree and Bungalow lined streets located a short distance from downtown. The Mordecai historic neighborhood was named for the family plantation on which it was developed. The Mordecai House (I) still survives in the area and is the centerpiece of the neighborhood and the nucleus of Mordecai Historic Park. Joel Lane built the house for his son in 1785, and in 1792 sold 1,000 acres of his land to the state to found the capital city. Development of Mordecai Place began in 1922.

Mordecai Place is a National Register Historic District. Because it not a locally designated district, exterior changes are *not* subject to design review by the Raleigh Historic Development Commission. The Raleigh City Mordecai Neighborhood Conservation Overlay Districts (NCOD) #1 & 2 overlap most of the Historic District. The NCOD limits lot sizes, setbacks and building heights of infill and new construction within the districts.

The Mordecai Citizens Advisory Council (CAC) is an active community group that meets monthly. Learn more at:

- [mordecai.org](http://mordecai.org)
- [rhdc.org](http://rhdc.org)
- [trianglewiki.org](http://trianglewiki.org)
- [raleighnc.gov/planning](http://raleighnc.gov/planning)
- [seaboardstationshops.org](http://seaboardstationshops.org)

**Mordecai Place National Historic District (Blue)**



\* 1230 Mordecai Dr  
Raleigh, NC 27604

**Schools & Colleges**

- A Conn Elementary School
- B Moore Square Magnet Middle School
- C St. Augustine's College
- D Exploris Charter School
- E William Peace University

**Parks & Museums**

- F Mordecai Mini Park
- G Oakwood Common
- H1 Oakwood Cemetery
- H2 Oakwood Dog Park
- I Mordecai Historic home & park
- J Moore Square/City Market
- K City of Raleigh (COR) Museum
- L NC Museums - History & Natural Science

**Other**

- M Krispy Kreme
- N Blount Street Commons - Gallery C
- O Burning Coal Theater
- P Old NC State Capitol
- Q NC Legislative Building
- R NC Governor's Mansion
- S Raleigh City Farm
- T Person Street shops - The Station, So So Books, Oak City Cycling, Yellow Dog Bread Co, Marsh Woodwinds, Nicole's Gallery, more.
- U Seaboard Station - 18 Seaboard, Brew Coffee Bar, ACE Hardware, Logans, Marigold Parlor, Galatea Boutique, J. Betski's, more.
- V Stanbury Restaurant, Escazu Chocolates
- W Side Street Restaurant
- Z1 Glenwood South entertainment district
- Z2 NC HQ for American Institute of Architects (AIA)
- Z3 NC Bar Association HQ

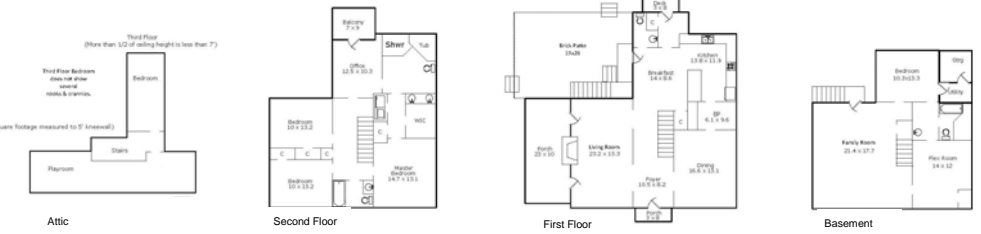

Copies of floor plan, flyer, neighborhood info and more are available on our web sites or upon request.  
Peter@PeterRumsey.com  
Debra@DebraSmith.com