

Walk everywhere  
restaurants,  
galleries,  
shops,  
museums,  
parks,  
work.



During the warmer months family friendly neighborhood concerts are a gathering place on the lawn of the Mordecai Historic House and park (I).

**Schools & Colleges**

- A Conn Elementary School
- B Moore Square Magnet Middle School
- C St. Augustine's College
- D Exploris Charter School
- E William Peace University

**Parks & Museums**

- F Mordecai Mini Park
- G Oakwood Common
- H1 Oakwood Cemetery
- H2 Oakwood Dog Park
- I Mordecai Historic home & park
- J Moore Square/City Market
- K City of Raleigh (COR) Museum
- L NC Museums - History & Natural Science

**Other**

- M Krispy Kreme
- N Blount Street Commons - Gallery C
- O Burning Coal Theater
- P Old NC State Capitol
- Q NC Legislative Building
- R NC Governor's Mansion
- S Stanbury Restaurant, Escazu Chocolates
- T Person Street shops - The Station, Oak City Cycling, PieBird, art galleries, Yellow Dog Bread Co, Wine Merchant, more.
- U Seaboard Station - Tyler's Taproom, 18 Seaboard, J. Betski's, ACE Hardware, Logans, Marigold Parlor, Phydeaux Pets, more.
- V Side Street Restaurant
- W The Oakwood Inn B&B (www.oakwoodinnbb.com)
- Z Glenwood South entertainment district
- ZZ NC HQ for American Institute of Architects (AIA)
- ZZZ Brookside Market & Deli



1216 Brookside Dr  
Raleigh, NC 27604

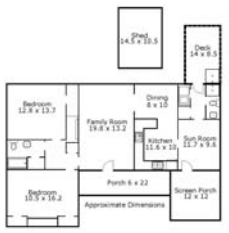

Copies of floor plan, flyer, neighborhood info and more are available on our web sites or upon request.